

SCHEMATIC DESIGN PRESENTATION

BIRDVILLE HIGH SCHOOL ADDITIONS & RENOVATIONS

BIRDVILLE INDEPENDENT SCHOOL DISTRICT

Huckabee



BIRDVILLE HIGH SCHOOL ADDITIONS & RENOVATIONS
BIRDVILLE INDEPENDENT SCHOOL DISTRICT

Acknowledgments	2
Narrative	3
Existing Site Plan	4
Site Plan	5
Existing Floor Plan	6
Floor Plan	7
Renderings	8-10
Space Program	11
Schedule	12



Birdville ISD

Dr. Darrell G. Brown	Superintendent
Jack McCarty	Board President
Dolores Webb	Board Vice President
Joe Tolbert	Board Secretary
Brad Greene	Board Member
Richard Davis	Board Member
Ralph Kunkel	Board Member
Cary D. Hancock	Board Member
Mike Seale	Associate Superintendent of Finance
Conan Mathson, CCM	Senior Officer – Design & Construction
John Hughes	District Architect
Jason Wells	Birdville High School Principal

Project Design Team

Tim McClure, AIA
Principal, Huckabee

Aubrey Slaybaugh, AIA, LEED AP
Associate Principal, Huckabee

Cameron Mason, AIA
Project Leader, Huckabee

Casey Casstevens
Design Leader, Huckabee

Civil Engineering
Schrickel Rollins & Associates
Arlington, TX

MEP Engineering
IEG Consulting Engineers
Dallas, TX

Structural Engineering
Huckabee
Fort Worth, TX

Technology/Security
Huckabee
Fort Worth, TX

Interior Design
Huckabee
Fort Worth, TX

ACKNOWLEDGMENTS



BIRDVILLE HIGH SCHOOL ADDITIONS & RENOVATIONS

BIRDVILLE INDEPENDENT SCHOOL DISTRICT

Project Introduction

As part of the 2014 Bond program, additions and renovations to Birdville High School were planned to achieve equity among the three high schools in the fine arts and athletics programs, to add additional science labs, and to replace the flooring throughout the campus. Opened in 1999, Birdville High School is now undersized in fine arts and some athletic areas compared to the other two high schools, which have more recently received significant additions and renovations. After evaluating both square footage and enrollment in these programs, the following drawings and program are the outcome of multiple discussions with Birdville High School staff on what will meet their needs now and in the future and be comparable with both Richland and Haltom High Schools.

Fine Arts

There are several site constraints surrounding the existing fine arts wing on the front of the building including a primary driveway and loading area that serves all fine arts programs. To keep site costs minimal and allow the campus to retain its current functionality, it was decided to reduce the addition around the existing band hall and create a separate addition east of the auditorium entrance to relocate and expand the choir program. By relocating choir, the band will absorb the existing choir spaces, keeping the band addition minimal. Across the corridor from the new choir addition, there will be a new dance hall and support spaces added. The existing dance hall, located west of the main competition gym, will remain for additional space for cheer leading to practice.

Athletics

There will be multiple athletic spaces added to the east of the existing athletics wing, extending toward the student parking lot. These include a practice gym with a full 94' court, weight room facilities, and additional girls' locker room areas. There will also be some minor renovations done in the existing locker areas, both boys and girls. The existing weight rooms will be converted to the mat room for wrestling (currently located in a portable building) and additional athletics storage.

Science

A single story addition of two biology science labs and associated prep rooms and storage rooms will be added on the southeast side of the two story academic wing.

Site

These additions will have minimal site impact. All existing drives and loading areas will remain. Due to the fall of the site toward the student parking lot, a retaining wall is expected on the east end of the athletics addition. Some relocation of geothermal lines will also occur at both the athletics and science additions.

Construction

Relocation of the geothermal lines is expected to begin in December of this year. Upon completion of that, construction on the additions may commence and will be completed in August of 2016. Renovations and flooring replacement will occur throughout the summer of 2016. All construction will be completed by August 2016 for the 2016-2017 school year.



EXISTING SITE PLAN

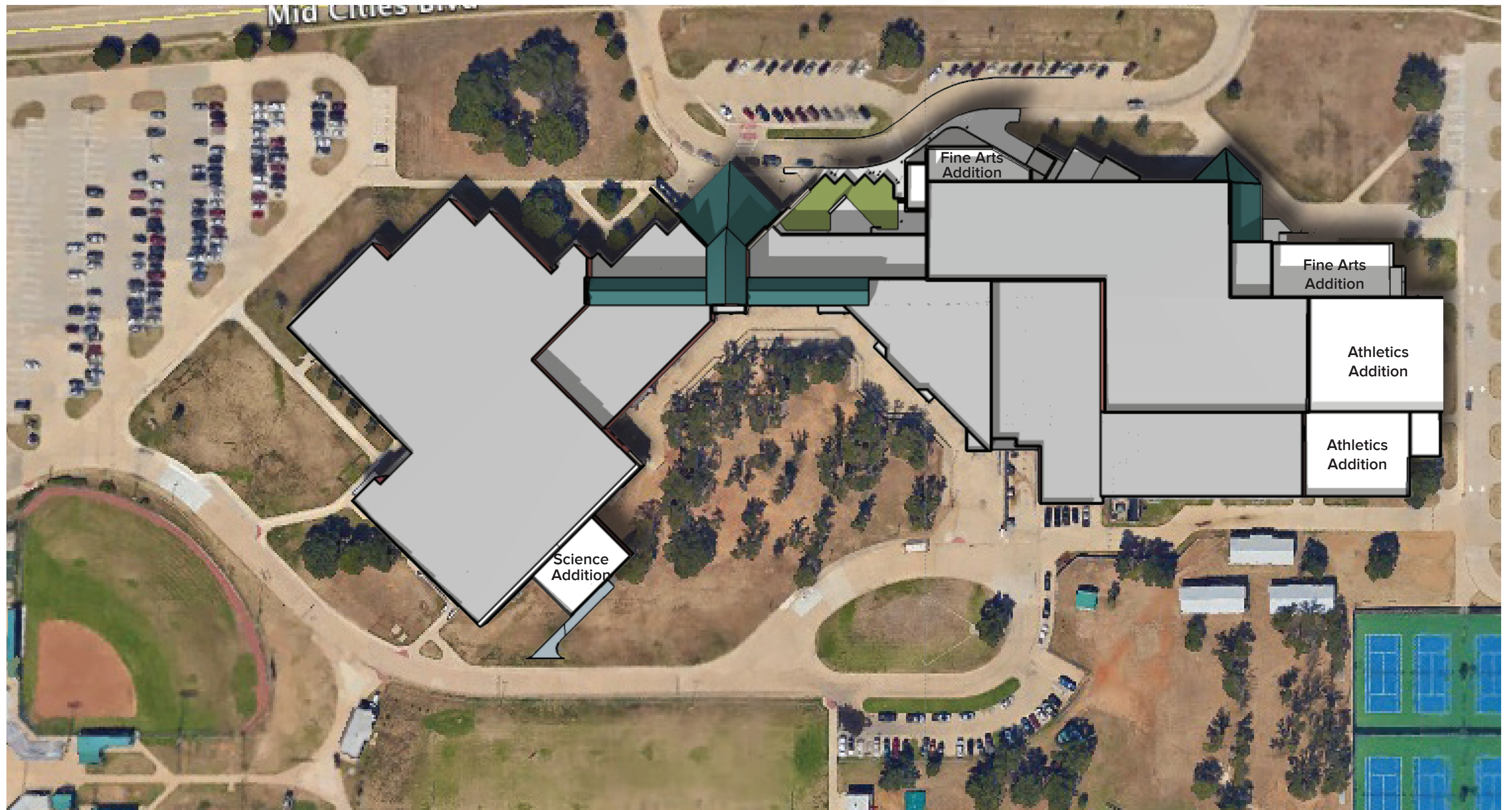



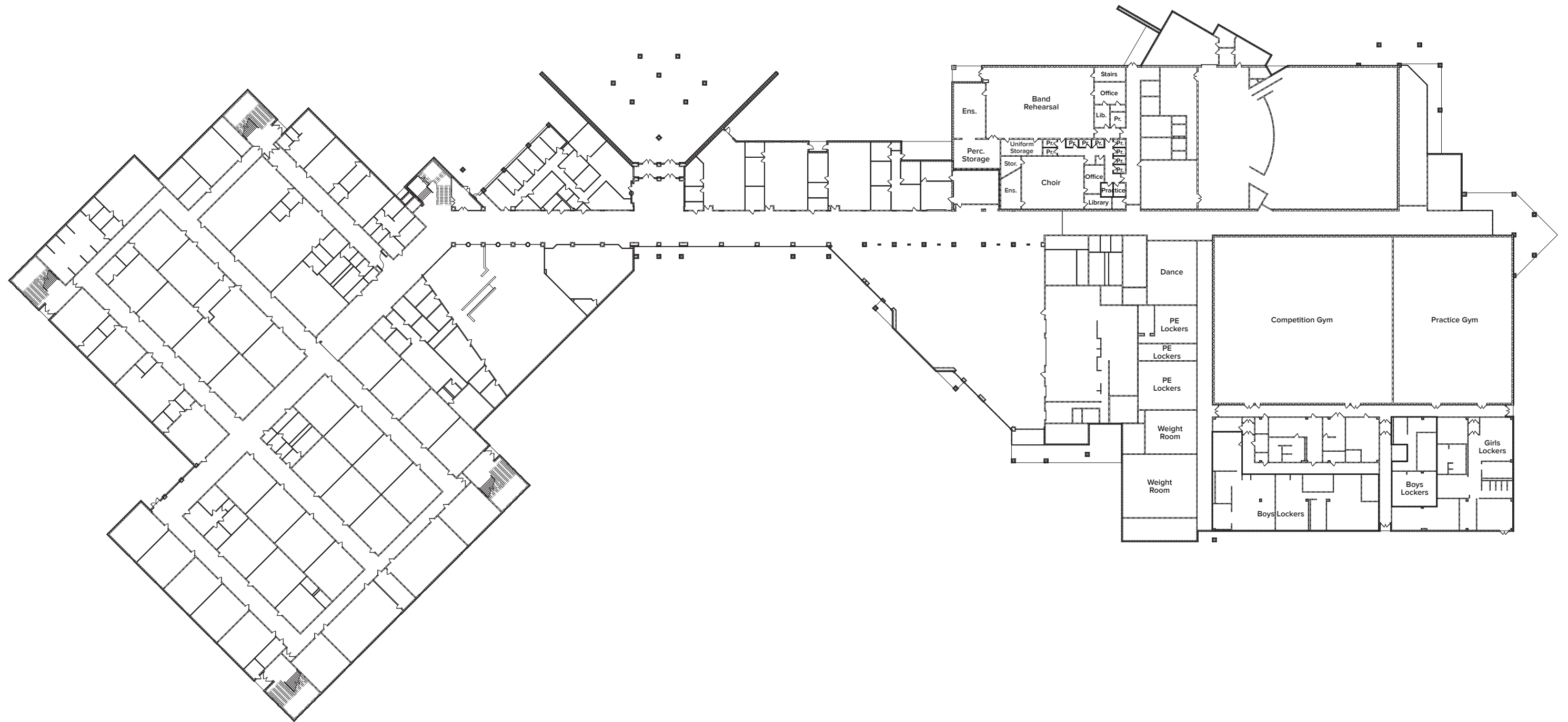

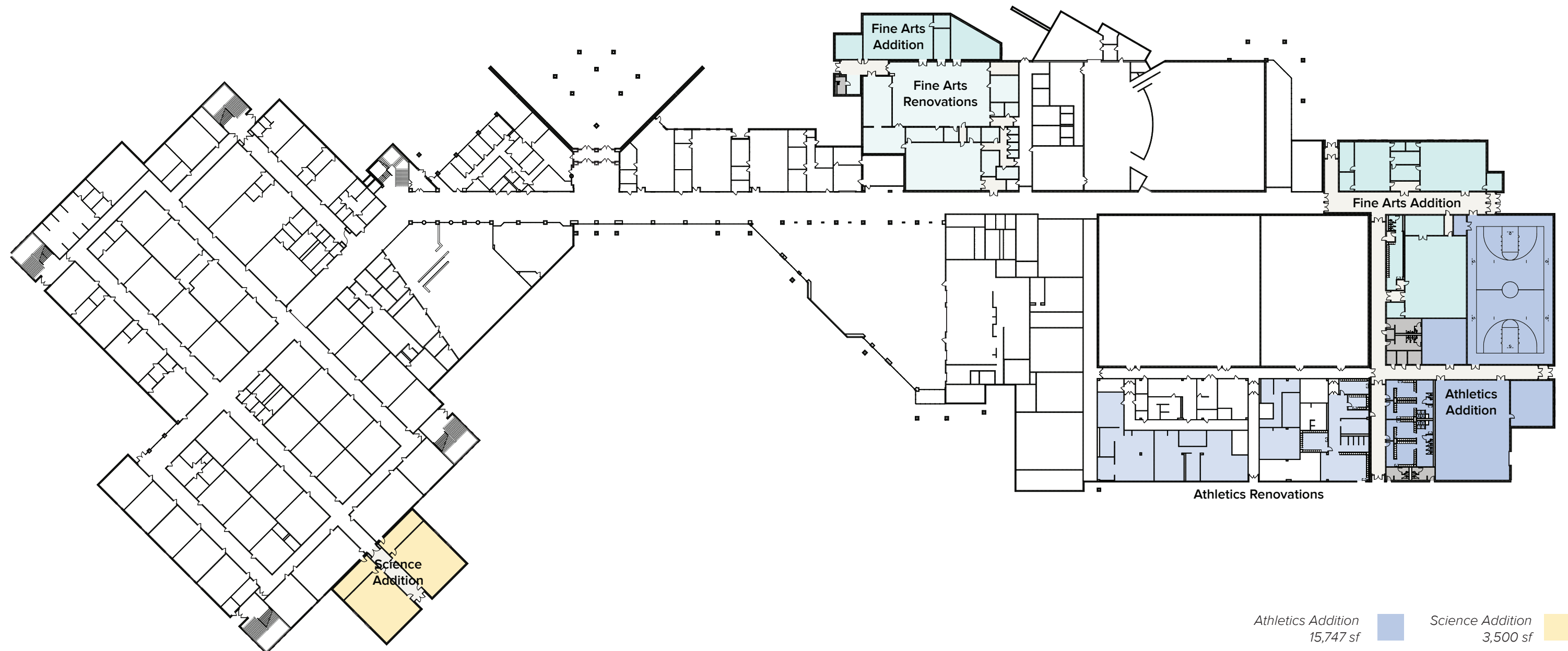

PROPOSED SITE PLAN



EXISTING FLOOR PLAN



<i>Athletics Addition</i> 15,747 sf		<i>Science Addition</i> 3,500 sf	
<i>Athletics Renovation</i> 12,285 sf		<i>Circulation*</i>	
<i>Fine Arts Addition</i> 12,088 sf		<i>Support Space*</i>	
<i>Fine Arts Renovation</i> 7,291 sf		<i>*10,734 sf combined</i>	

FLOOR PLAN



BAND ADDITION EXTERIOR RENDERING



CHOIR ADDITION EXTERIOR RENDERING

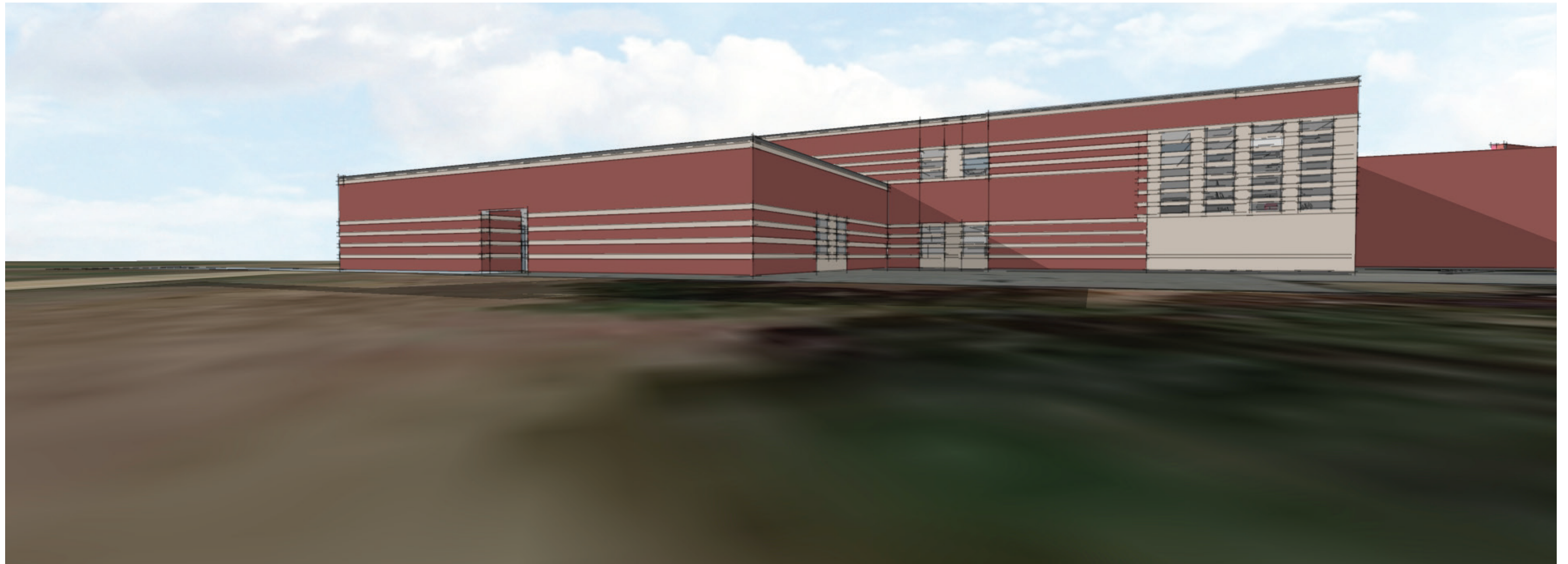

SCIENCE ADDITION EXTERIOR RENDERING

Birdville High School		Existing	New Construction	Renovation	Increase/ (Decrease)
Science			3,900		3,900
	Science Lab		1,550		1,550
	Science Lab		1,550		1,550
	Prep Room & Storage		400		400
	Prep Room & Storage		400		400
Fine Arts		8,637	12,088	7,291	10,742
Band/Percussion		4,762	4,118	7,291	6,647
	Band Hall	3,462		3,462	0
	Second Band Rehearsal Space			1,943	1,943
	Percussion/ Ensemble Room	500	1,668		1,168
	Office(s)	350	100	300	50
	Music Library	150	400		250
	General Storage			300	300
	Instrumental Storage		550	1,286	1,836
	Uniform Storage	300	300		0
	Marching Equip. Storage		750		750
	Music Theory Laboratory		350		350
Choir		2,283	3,852	0	1,569
	Choir Hall	1,450	1,782		332
	Second Choir Rehearsal Space	310	940		630
	Office	226	238		12
	Music Library	153	212		59
	General Storage		144		144
Dance		1,592	4,118	0	2,526
	Dance Hall	1,408	2,818		1,410
	Office	184	151		(33)
	Storage		404		404
	Lockers/Restrooms		745		745
Athletics		12,158	15,747	12,285	15,874
	Practice Gym		7,020		7,020
	Primary Weight Room	2,058	4,060		2,002
	Secondary Weight Room	983		1,110	127
	Wrestling/Mat Room			2,058	2,058
	Team Room		1,004		1,004
	Athletics Storage		135		135
	Athletics Storage		983		983
	Girls Lockers/Restrooms	2,640	2,230	2,640	2,230
	Boys Lockers/Restrooms	6,477		6,477	0
	Tennis Restrooms		315		315
Subtotal Net Area (s.f.)- Types of Construction			31,735	19,576	
Support Spaces (MEPT,RR), Circulation, Walls			10,734		
TOTAL NET AREA (s.f.)			42,469	19,576	
TOTAL GROSS AREA (s.f.)				62,045	



BIRDVILLE HIGH SCHOOL ADDITIONS & RENOVATIONS
BIRDVILLE INDEPENDENT SCHOOL DISTRICT

SD Approval	6/25/15
Issue Docs for Bid	10/8/15
Board Award Construction Contract	11/19/15
Substantial Completion	8/1/16



MORE THAN ARCHITECTS