

DESIGN DEVELOPMENT PRESENTATION

BIRDVILLE HIGH SCHOOL ADDITIONS & RENOVATIONS

BIRDVILLE INDEPENDENT SCHOOL DISTRICT

Huckabee



BIRDVILLE HIGH SCHOOL ADDITIONS & RENOVATIONS
BIRDVILLE INDEPENDENT SCHOOL DISTRICT

| | |
|------------------------|-------|
| Acknowledgments | 2 |
| Narrative | 3 |
| Existing Site Plan | 4 |
| Site Plan | 5 |
| Existing Floor Plan | 6 |
| Floor Plan – Base Bid | 7 |
| Floor Plan – Alternate | 8 |
| Enlarged Floor Plans | 9-12 |
| Phasing Plan | 13 |
| Renderings | 14-16 |
| Space Program | 17 |
| Schedule | 18 |



**BIRDVILLE HIGH SCHOOL
ADDITIONS & RENOVATIONS**

BIRDVILLE INDEPENDENT SCHOOL DISTRICT

Birdville ISD

| | |
|----------------------|--|
| Dr. Darrell G. Brown | Superintendent |
| Jack McCarty | Board President |
| Dolores Webb | Board Vice President |
| Joe Tolbert | Board Secretary |
| Brad Greene | Board Member |
| Richard Davis | Board Member |
| Ralph Kunkel | Board Member |
| Cary D. Hancock | Board Member |
| Mike Seale | Associate Superintendent of Finance |
| Conan Mathson, CCM | Senior Officer – Design & Construction |
| John Hughes | District Architect |
| Jason Wells | Birdville High School Principal |

Project Design Team

Tim McClure, AIA
Principal, Huckabee

Aubrey Slaybaugh, AIA, LEED AP
Associate Principal, Huckabee

Cameron Mason, AIA
Project Leader, Huckabee

Casey Casstevens
Design Leader, Huckabee

Civil Engineering

Schricket Rollins & Associates
Arlington, TX

MEP Engineering

IEG Consulting Engineers
Dallas, TX

Structural Engineering

Huckabee
Fort Worth, TX

Technology/Security

Huckabee
Fort Worth, TX

Interior Design

Huckabee
Fort Worth, TX

ACKNOWLEDGMENTS



BIRDVILLE HIGH SCHOOL ADDITIONS & RENOVATIONS

BIRDVILLE INDEPENDENT SCHOOL DISTRICT

Project Introduction

As part of the 2014 Bond program, additions and renovations to Birdville High School were planned to achieve equity among the three high schools in the fine arts and athletics programs, to add additional science labs, and to replace the flooring throughout the campus. Opened in 1999, Birdville High School is now undersized in fine arts and some athletic areas compared to the other two high schools, which have more recently received significant additions and renovations. After evaluating both square footage and enrollment in these programs, the following drawings and program are the outcome of multiple discussions with Birdville High School staff on what will meet their needs now and in the future and be comparable with both Richland and Haltom High Schools.

Fine Arts

There are several site constraints surrounding the existing fine arts wing on the front of the building including a primary driveway and loading area that serves all fine arts programs. To keep site costs minimal and allow the campus to retain its current functionality, it was decided to reduce the addition around the existing band hall and create a separate addition east of the auditorium entrance to relocate and expand the choir program. The choir addition will include two new choir rehearsal spaces, multiple practice rooms, office, music library, and storage spaces. As part of the choir relocation, improvements will be made on site to emphasize the existing auditorium entrance as the public entrance for performances, including sidewalk enhancements, improving the lighting and de-emphasizing the new entry between fine arts and athletics.

By relocating choir, the band will absorb the existing choir spaces, keeping this addition minimal. The renovated spaces will include a second band hall (located in the original choir hall and ensemble spaces) and modified offices, instrument storage, and general storage. By relocating the instrument storage, the primary band hall will also gain more usable square footage. In the addition, a percussion rehearsal space, office, uniform storage, and marching band storage will be added. An alternate will also be considered to add a music theory classroom, faculty restroom and ice machine area.

Across the corridor from the new choir addition, there will be a new dance hall added, doubling the size of their current space. A new locker room, office, and storage will also be provided. The existing dance hall, located west of the main competition gym, will remain for additional space for cheer leading to practice.

Athletics

There will be multiple athletic spaces added to the east of the existing athletics wing, extending toward the student parking lot. There will be a practice gym added with a full 94' court, resulting in three gyms on campus. If the budget allows, there will be an alternate for extra square footage in the gym for 250 bleachers seats. Two new weight rooms will be added, almost doubling what they currently have. The large weight room will have views toward the stadium. An alternate for a possible team room is also shown next to the weight rooms. Additional girls' locker room areas will be added and some minor renovations done in the existing locker area so that each sport can have their own space and so that they are more comparable to the boys' locker rooms on campus. Finally, restrooms will be added to the south side of the building for access from the tennis courts without patrons needing to enter the building.

In the existing boys' locker rooms, new lockers and paint are planned. The existing weight rooms will be converted to the mat room for wrestling (currently located in a portable building) and additional athletics storage.

Science

A single story addition of two biology science labs and associated prep rooms and storage rooms will be added on the southeast side of the two story academic wing. These labs will be modeled after the recent modular labs added at Haltom High School.

Site

These additions will have minimal site impact. All existing drives and loading areas will remain. Due to the fall of the site toward the student parking lot, a retaining wall is expected on the east end of the athletics addition. Some relocation of geothermal lines will also occur at the athletics and science additions.

Construction

Relocation of the geothermal lines is expected to begin in December of this year. Upon completion of that, construction on the additions may commence and will be completed in August of 2016. Renovations and flooring replacement will occur throughout the summer of 2016. All construction will be completed by August 2016 for the 2016-2017 school year.



EXISTING SITE PLAN

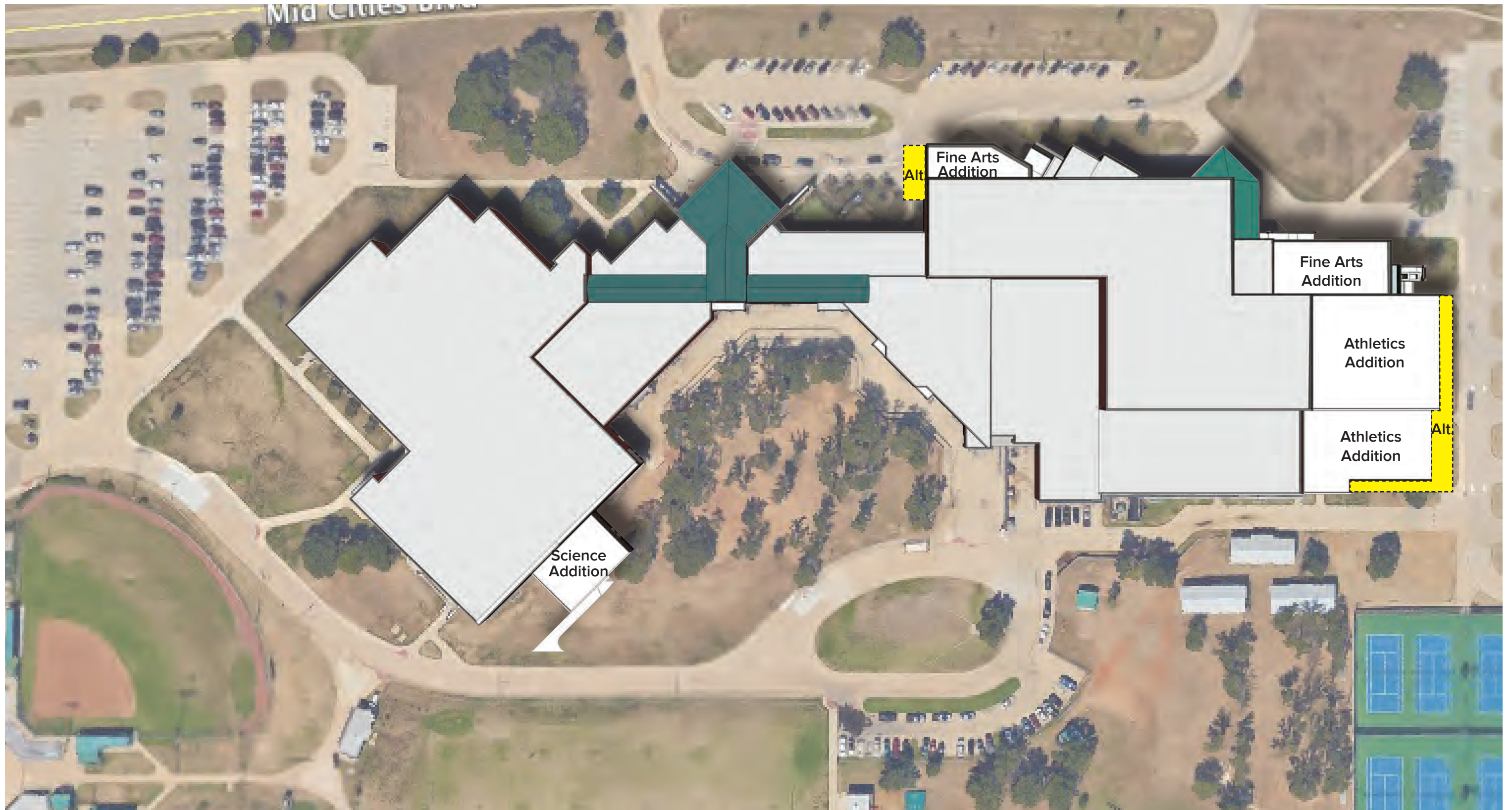



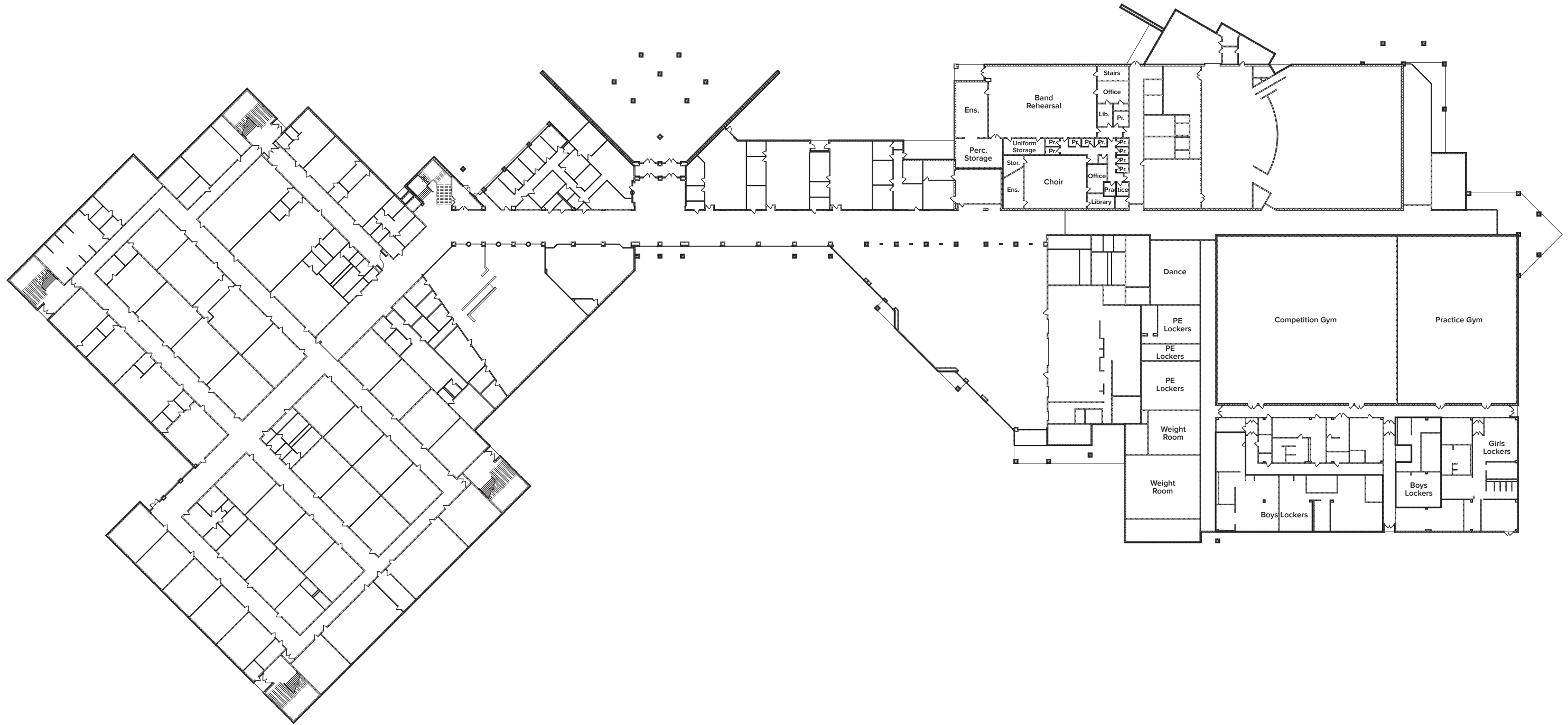

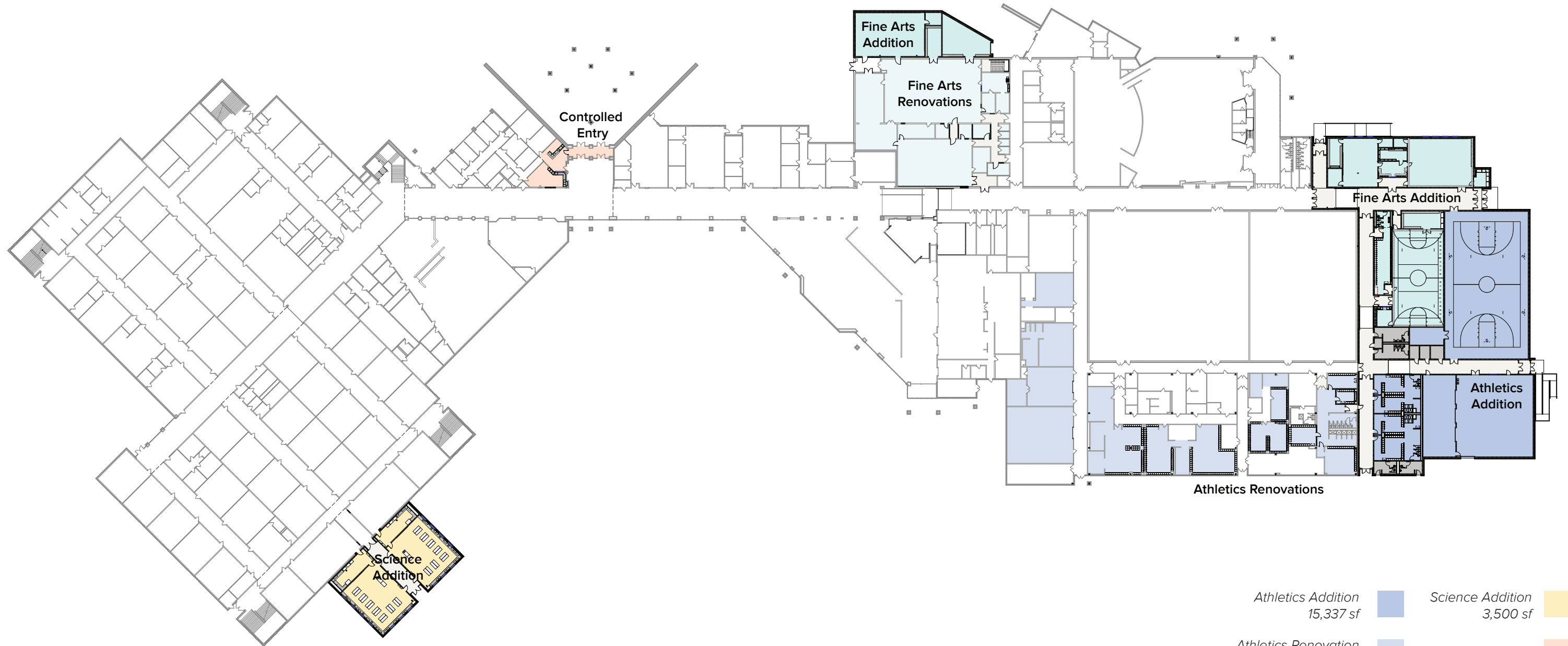

PROPOSED SITE PLAN



EXISTING FLOOR PLAN

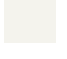
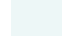





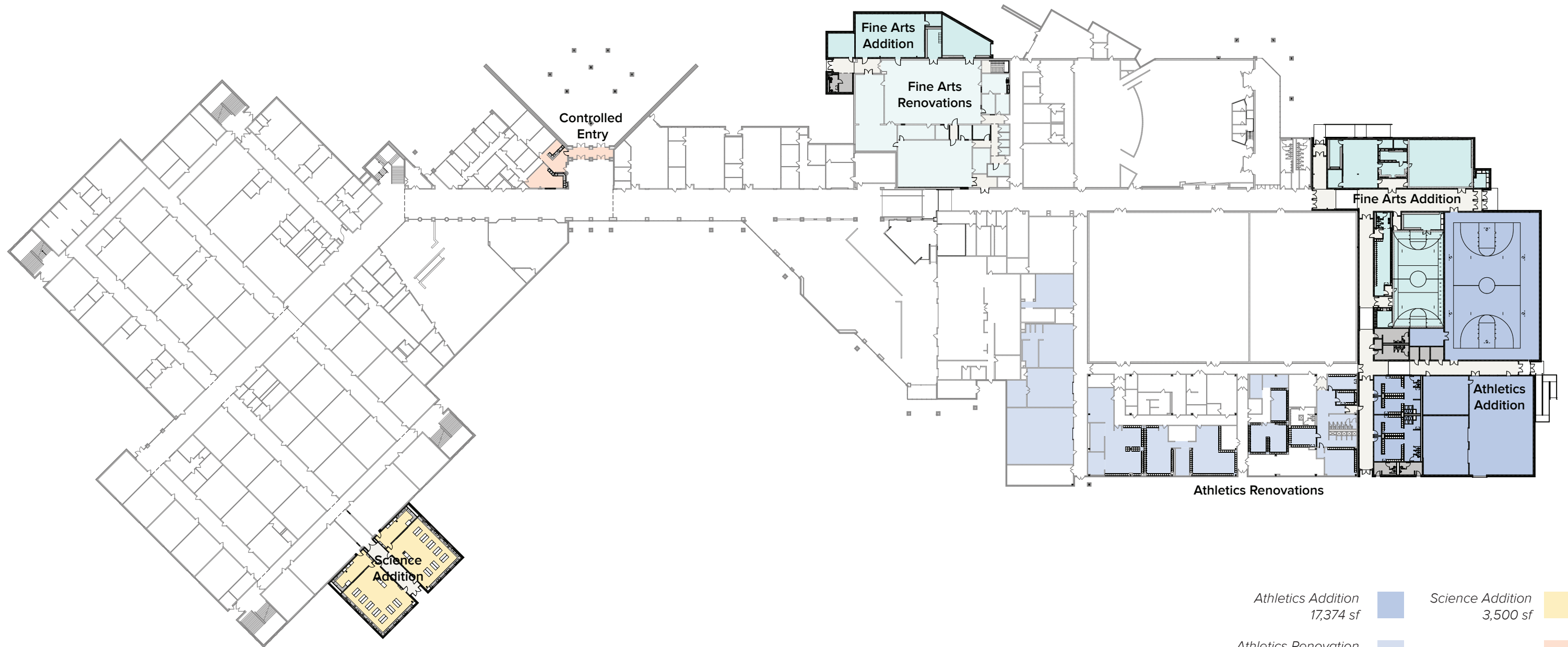

| | | | |
|-----------------------------------|---|---|---|
| Athletics Addition 15,337 sf |  | Science Addition 3,500 sf |  |
| Athletics Renovation 12,285 sf |  | Controlled Entry  | |
| Fine Arts Addition 11,973 sf |  | Circulation*  | |
| Fine Arts Renovation 7,291 sf |  | Support Space*  | |

*10,734 sf combined

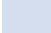
FLOOR PLAN: BASE BID

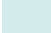
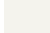
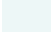

| | | | |
|-----------------------------------|---|---|---|
| Athletics Addition 17,374 sf |  | Science Addition 3,500 sf |  |
| Athletics Renovation 12,285 sf |  | Controlled Entry  | |
| Fine Arts Addition 12,952 sf |  | Circulation*  | |
| Fine Arts Renovation 7,291 sf |  | Support Space*  | |

*10,734 sf combined

FLOOR PLAN: WITH ALTERNATES

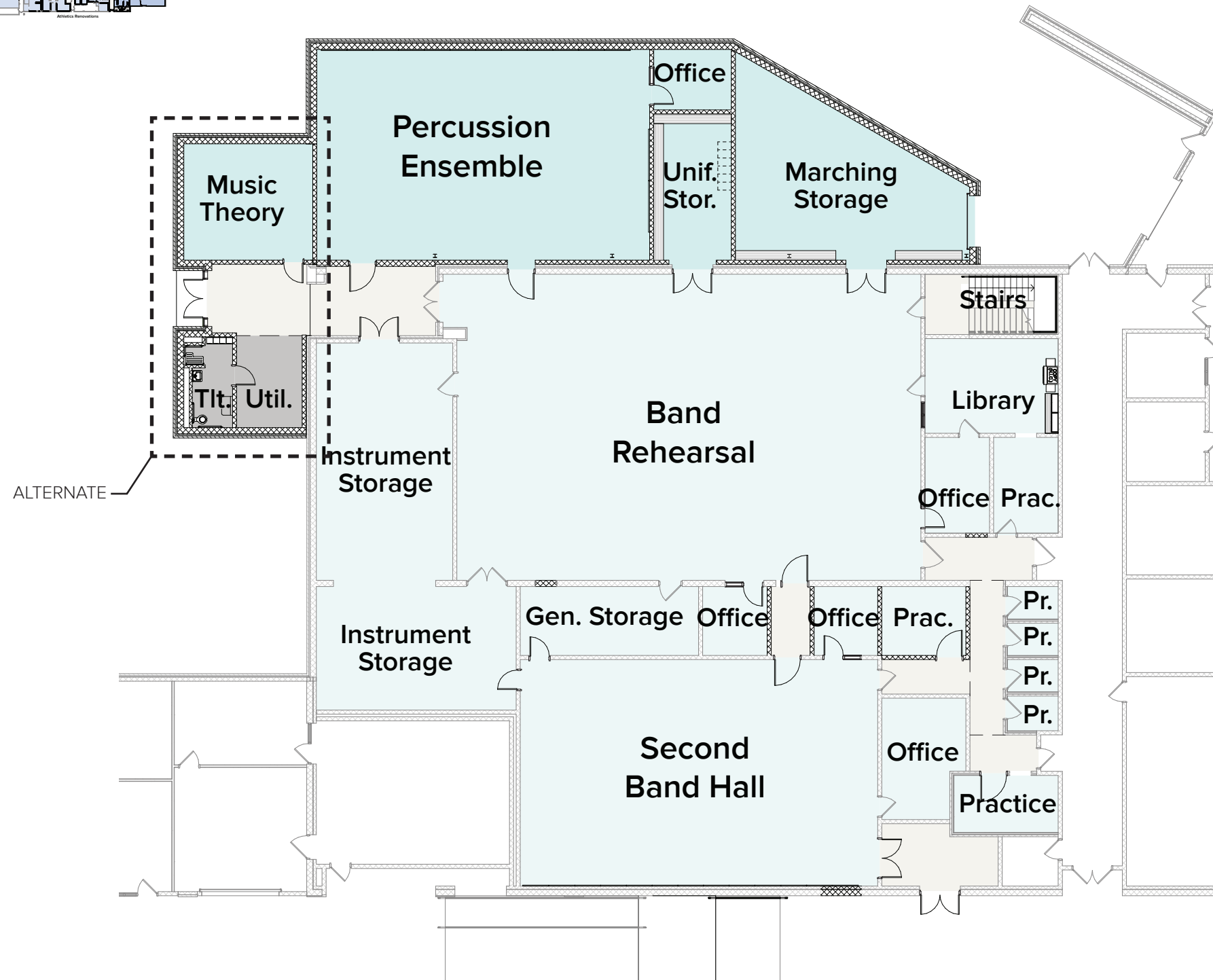
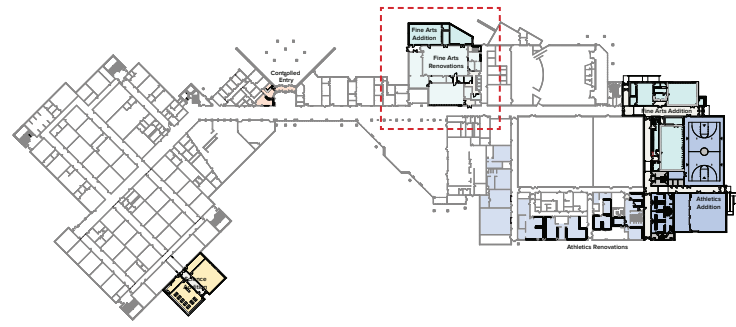

- Academic Space
- Athletic Space
- Fine Arts
- Circulation
- Support Space

ENLARGED FLOOR PLAN: BAND ADDITION

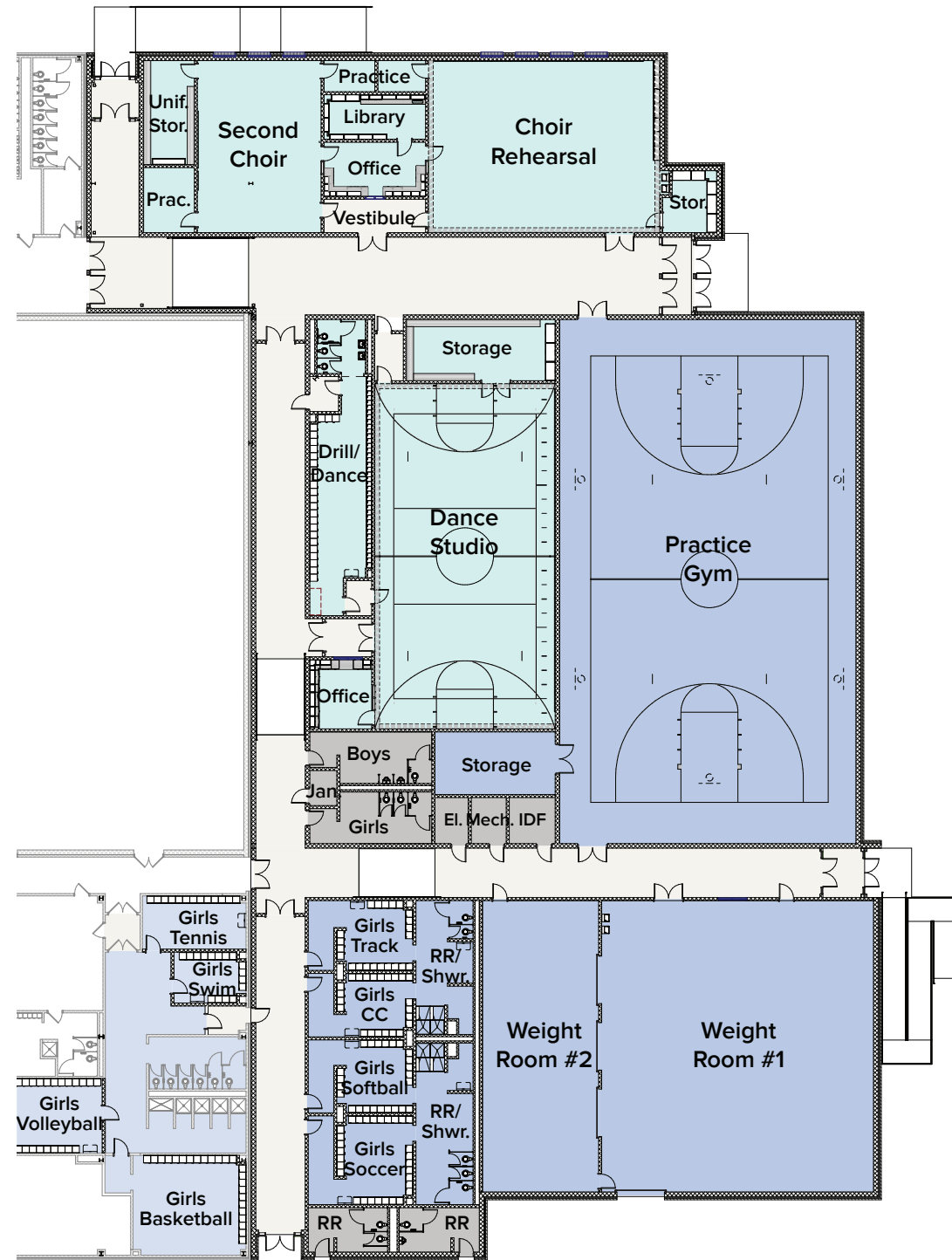
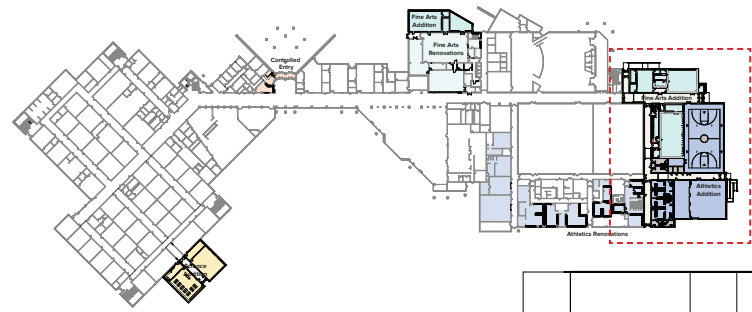

BASE BID

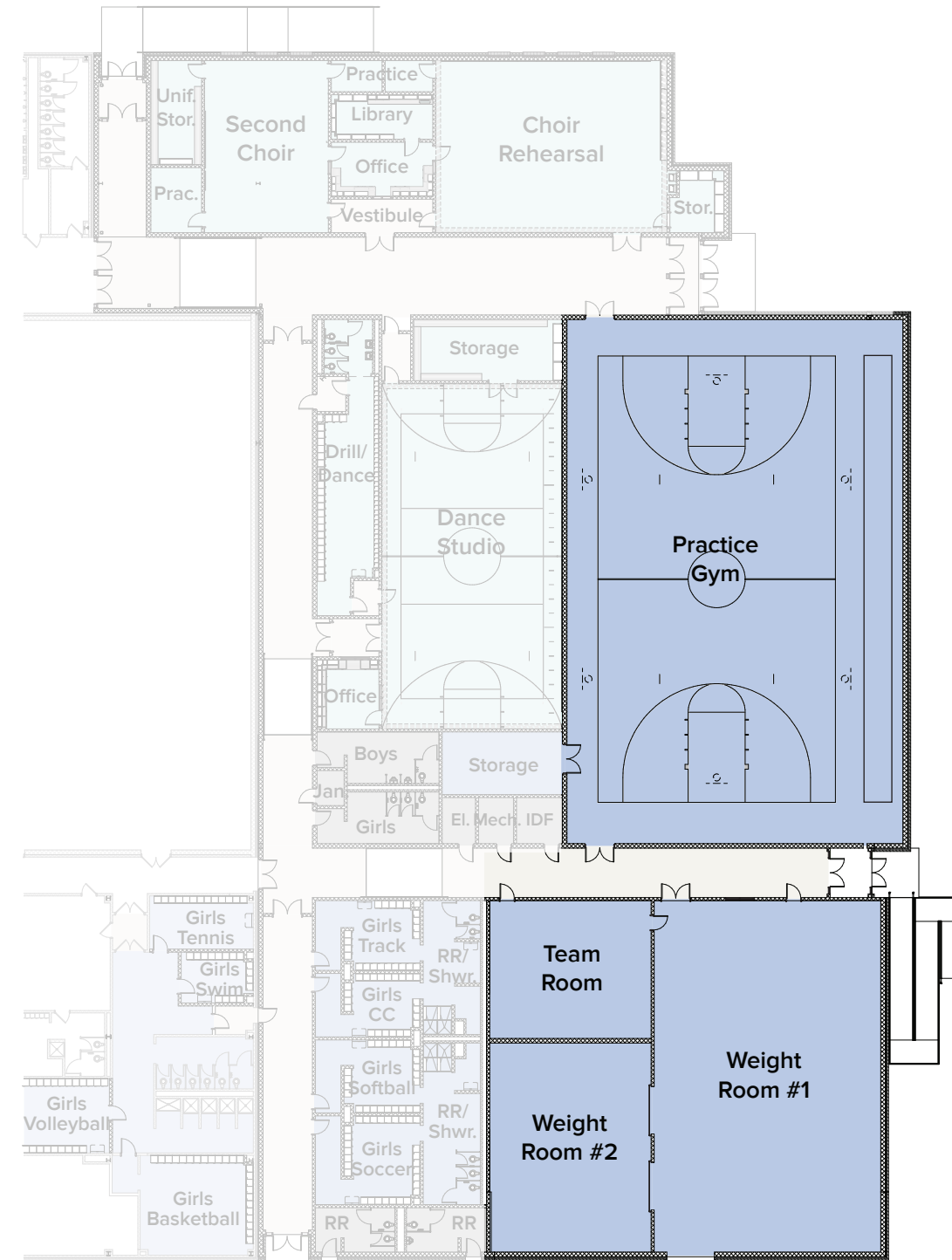

ALTERNATE BID

- Academic Space
- Athletic Space
- Fine Arts
- Circulation
- Support Space

ENLARGED FLOOR PLAN: CHOIR/ATHLETICS ADDITIONS

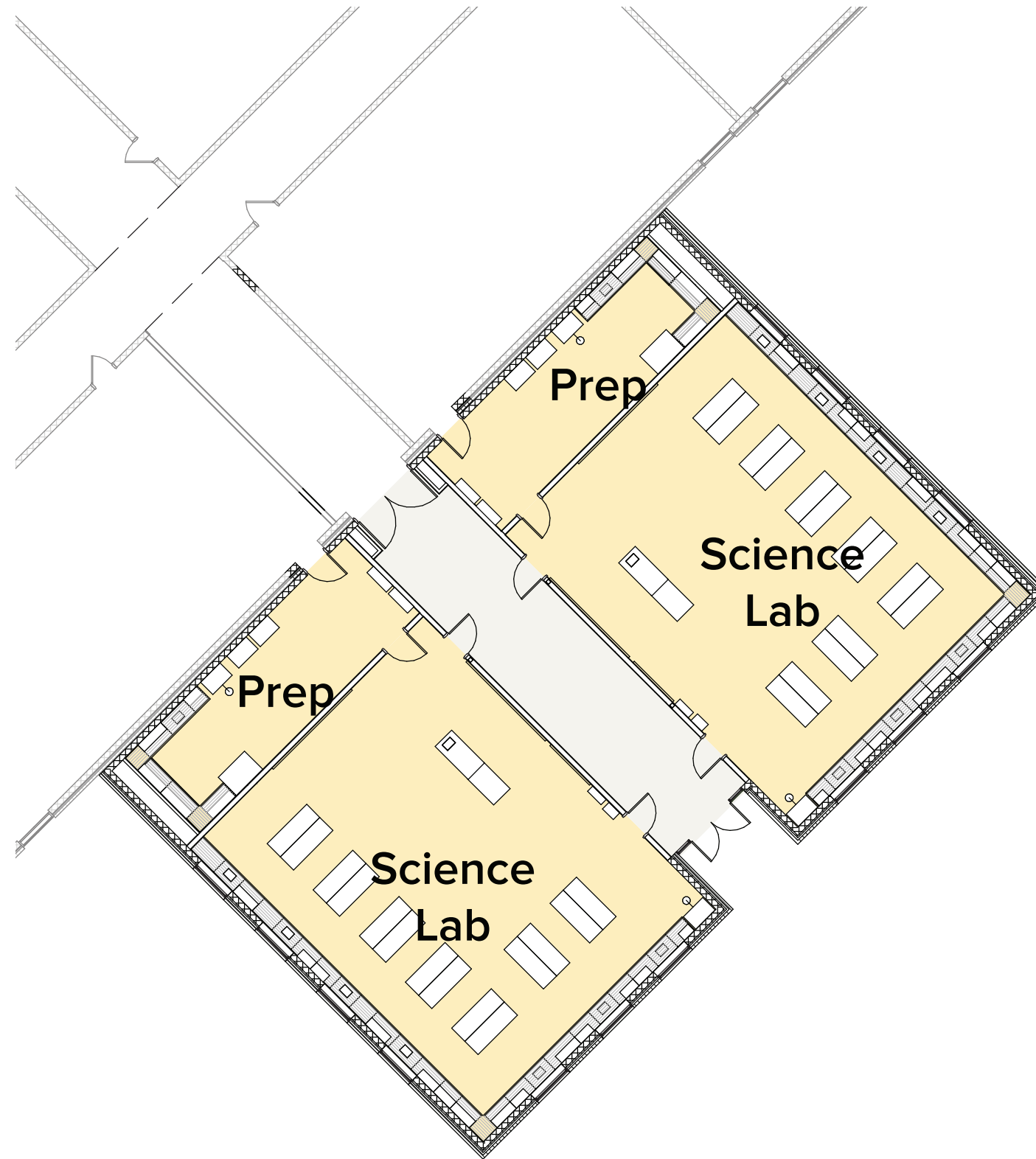
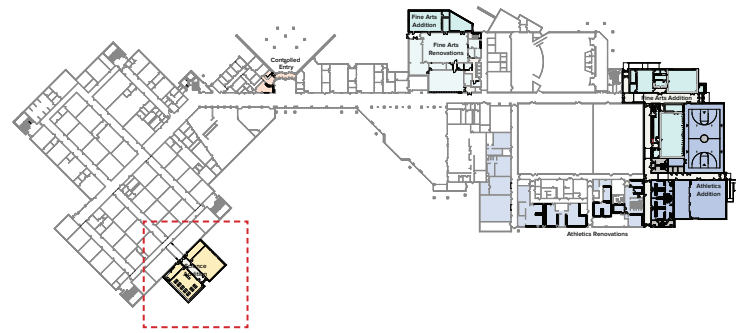

- Academic Space ■
- Athletic Space ■
- Fine Arts ■
- Circulation ■
- Support Space ■

ENLARGED FLOOR PLAN: SCIENCE ADDITION

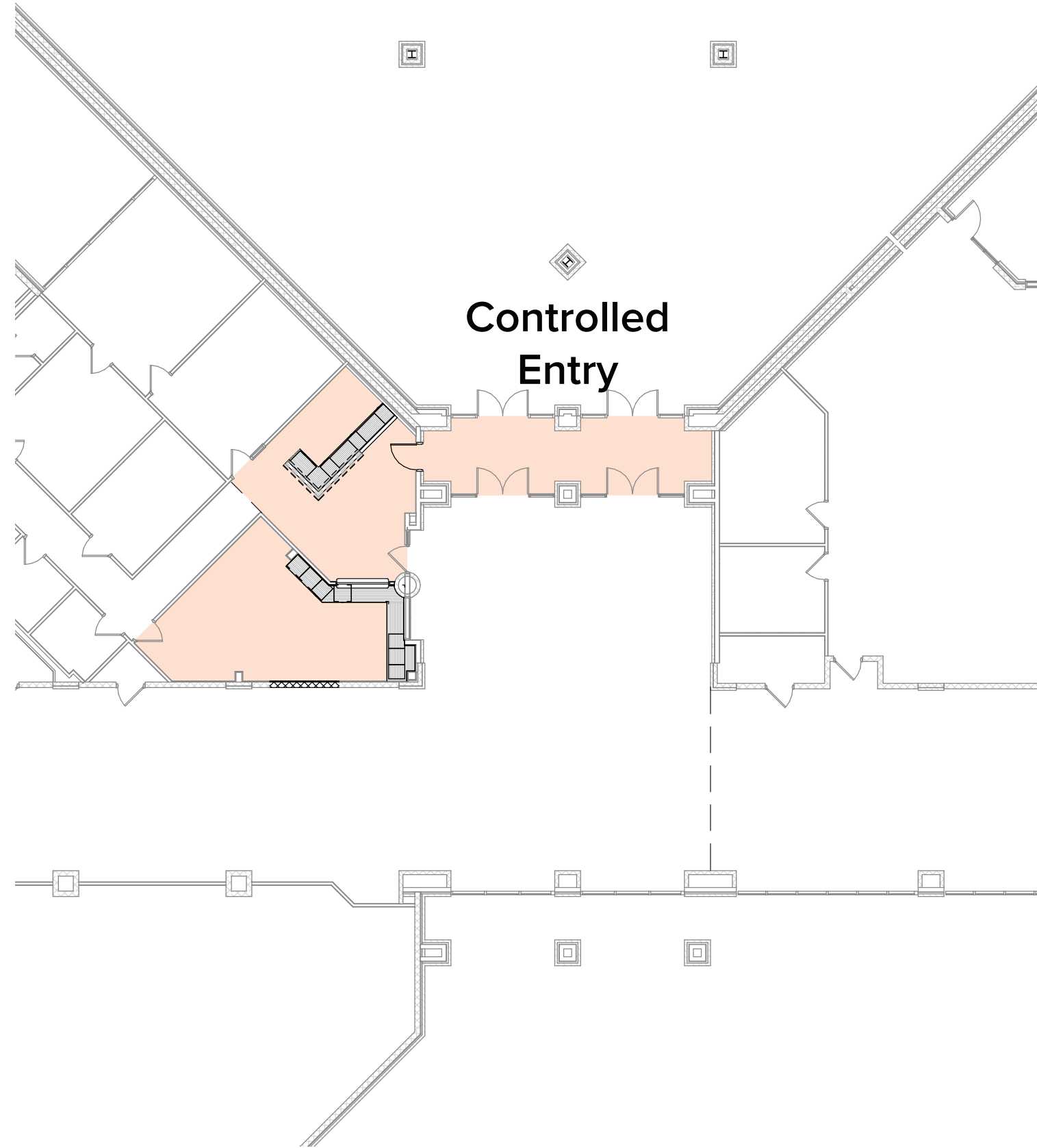
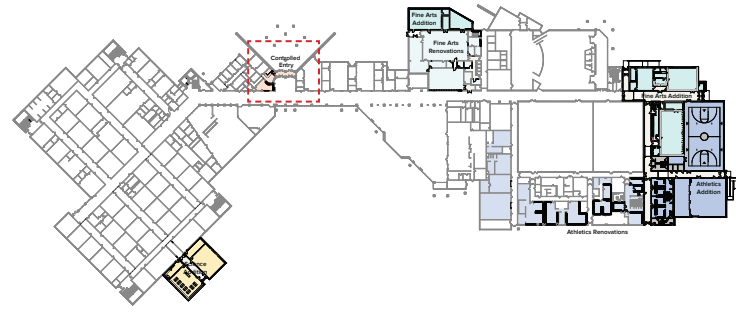

Administration 

ENLARGED FLOOR PLAN: CONTROLLED ENTRY

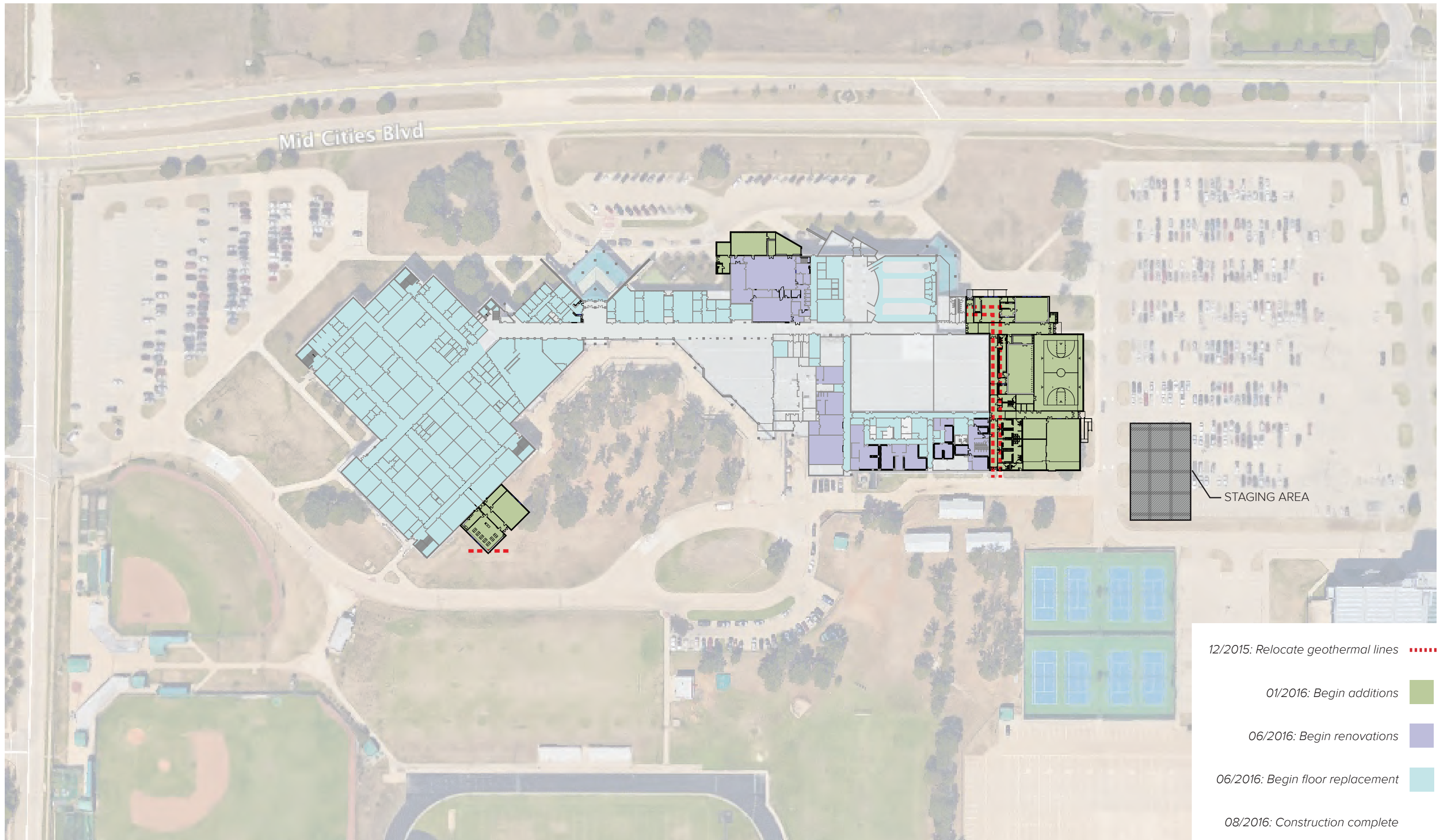

- 12/2015: Relocate geothermal lines - - - - -
- 01/2016: Begin additions ■
- 06/2016: Begin renovations ■
- 06/2016: Begin floor replacement ■
- 08/2016: Construction complete

PHASING PLAN



FRONT BAND ADDITION EXTERIOR RENDERING



CHOIR/ATHLETIC ADDITION EXTERIOR RENDERING

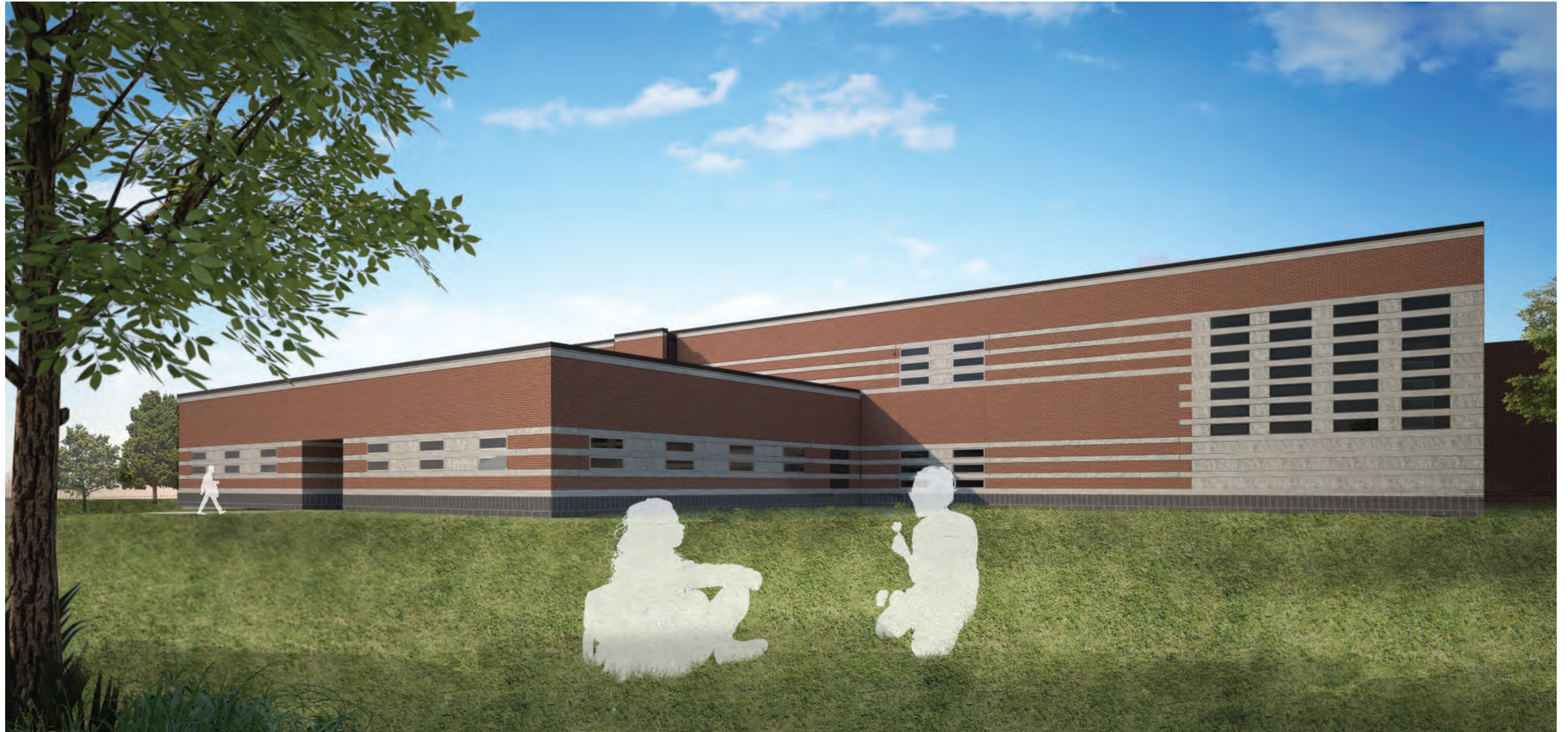

SCIENCE ADDITION EXTERIOR RENDERING

| Birdville High School | | Existing | New Construction | Renovation | Increase/ (Decrease) |
|--|------------------------------|----------|------------------|---------------|-------------------------|
| Science | | | 3,900 | | 3,900 |
| | Science Lab | | 1,550 | | 1,550 |
| | Science Lab | | 1,550 | | 1,550 |
| | Prep Room & Storage | | 400 | | 400 |
| | Prep Room & Storage | | 400 | | 400 |
| Fine Arts | | 8,637 | 12,088 | 7,291 | 10,742 |
| Band/Percussion | | 4,762 | 4,118 | 7,291 | 6,647 |
| | Band Hall | 3,462 | | 3,462 | 0 |
| | Second Band Rehearsal Space | | | 1,943 | 1,943 |
| | Percussion/ Ensemble Room | 500 | 1,668 | | 1,168 |
| | Office(s) | 350 | 100 | 300 | 50 |
| | Music Library | 150 | 400 | | 250 |
| | General Storage | | | 300 | 300 |
| | Instrumental Storage | | 550 | 1,286 | 1,836 |
| | Uniform Storage | 300 | 300 | | 0 |
| | Marching Equip. Storage | | 750 | | 750 |
| | Music Theory Laboratory | | 350 | | 350 |
| Choir | | 2,283 | 3,852 | 0 | 1,569 |
| | Choir Hall | 1,450 | 1,782 | | 332 |
| | Second Choir Rehearsal Space | 310 | 940 | | 630 |
| | Office | 226 | 238 | | 12 |
| | Music Library | 153 | 212 | | 59 |
| | General Storage | | 144 | | 144 |
| Dance | | 1,592 | 4,118 | 0 | 2,526 |
| | Dance Hall | 1,408 | 2,818 | | 1,410 |
| | Office | 184 | 151 | | (33) |
| | Storage | | 404 | | 404 |
| | Lockers/Restrooms | | 745 | | 745 |
| Athletics | | 12,158 | 15,747 | 12,285 | 15,874 |
| | Practice Gym | | 7,020 | | 7,020 |
| | Primary Weight Room | 2,058 | 4,060 | | 2,002 |
| | Secondary Weight Room | 983 | | 1,110 | 127 |
| | Wrestling/Mat Room | | | 2,058 | 2,058 |
| | Team Room | | 1,004 | | 1,004 |
| | Athletics Storage | | 135 | | 135 |
| | Athletics Storage | | 983 | | 983 |
| | Girls Lockers/Restrooms | 2,640 | 2,230 | 2,640 | 2,230 |
| | Boys Lockers/Restrooms | 6,477 | | 6,477 | 0 |
| | Tennis Restrooms | | 315 | | 315 |
| Subtotal Net Area (s.f.)- Types of Construction | | | 31,735 | 19,576 | |
| Support Spaces (MEPT,RR), Circulation, Walls | | | 10,734 | | |
| TOTAL NET AREA (s.f.) | | | 42,469 | 19,576 | |
| TOTAL GROSS AREA (s.f.) | | | | 62,045 | |



BIRDVILLE HIGH SCHOOL ADDITIONS & RENOVATIONS
BIRDVILLE INDEPENDENT SCHOOL DISTRICT

| | |
|---|----------|
| DD Approval | 7/23/15 |
| Issue Docs for Bid | 10/8/15 |
| Board Award Construction Contract | 11/19/15 |
| Substantial Completion | 8/1/16 |



MORE THAN ARCHITECTS